



The perfect fit

Opting for a bespoke design helped one couple transform their difficult space into a stylish working kitchen.

Left These hand-painted Edwin Loxley units from Churchwood Design are Georgian-themed and flank either side of the reclaimed chimney breast – the focal point for Wendy's kitchen.

When Wendy and Chris Parker-Foers transformed their kitchen, the first problem that struck them was its awkwardly-shaped design. With four doors leading out of this room space was limited, as their bespoke kitchen specialist Mark Ambler of Churchwood Design points out: "With so many doors leading out of the room, it was only possible to put units on two sides."

However, Wendy knew her dream kitchen was in capable hands as Mark had recently updated her friend's kitchen, complete with a island unit. Wendy explains: "We hoped Mark would follow suit with a central island to help maximise space and create an ideal nesting place for our integrated microwave, a warming drawer and six pan drawers."

Working closely with the couple, Mark devised an ingenious plan whereby the entire kitchen would be designed around an old chimney breast, which Wendy and Chris had already painstakingly exposed to give the >>



INSIDE INFO:

Who lives here? Wendy Parker-Foers, 50, her husband, Chris, 53, and two Labrador/Terrier cross dogs, Bonnie and Clyde.

House history: The house was built in around 1780, in Yorkshire, and has been in the family for over 100 years.

Kitchen profile: Edwin Loxley kitchen fitted by Mark Ambler of Churchwood Design. Prices start from around £15,000.

KITCHEN FLOOR PLAN:

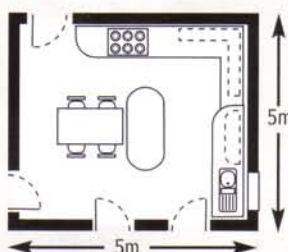



FOCUS ON:

awkwardly-shaped kitchens

- Opt for a clean run of units to provide you with plenty of storage space.
- Use light painted units to promote a feeling of space and help bounce light around the room.
- Roman blinds will create a less-fussy, neat approach to your windows for a more streamlined look.
- Install down-lighting under wall cabinets to brighten every corner which will create an illusion of more space.

room more character. Mark enhanced this feature by installing an impressive Lacanche Macon range below with an elegant over mantel shelf and panelling. He then framed the appliance with a seamless run of Edwin Loxley cabinetry either side, providing plenty of stylish storage space that accommodates two integrated fridges and a dishwasher. "The drawers are dovetailed front and rear, and the wood is primed and coated by hand in oil-based Dulux paint to match the ivory range," explains Mark.

It took just six weeks for the project to reach fruition. "In that time, we not only ripped out the existing kitchen, but also demolished the entire floor, all six inches of concrete and put in wet-system underfloor heating before concreting it over again," explains Wendy. For the flooring, the couple picked up

Jerusalem reclaimed limestone at the Lapidica showroom in Harrogate, which "looks like it's been there for ever". They opted for worktops in neutral shades for a natural blend. She reveals: "We actually went directly to the granite supplier's yard and picked out our own piece to ensure we had the exact look we required." This has been contrasted with another natural worktop in a different texture, a brownish red Iroko hardwood design.

The walls were painted in Loam from Sanderson's William Morris range, now sadly discontinued, and the single sash window over the sink has been dressed with stripy blinds in Pavilion Cord from John Lewis. The whole look was softened with under lighting beneath the wall cabinets that was planned and installed by Churchwood Design.

"As we entertain a lot, and Chris in particular enjoys cooking, it's important that the kitchen is as useful as it is beautiful." Wendy adds: "Often guests congregate here before going through to the separate dining room, so it's nice that it's so welcoming." **PH**

Above from left

An impressive Lacanche Macon range suits the couple's cooking needs perfectly; granite, which the couple picked up from a suppliers yard, tops the units neatly and complements the Jerusalem reclaimed limestone flooring; accessories like plates on the overmantel, which were inherited by Wendy's family, evoke a nostalgic sense of the past.

Right Shapely wall cabinets echo the curved iroko countertop of Wendy's tongue and grooved island unit.



ADDRESS BOOK

- AEG** (dishwasher), visit www.aeg-electrolux.co.uk
- Bosch** (fridge), tel: 01908 328200 or visit www.bosch.co.uk
- Churchwood Design** (kitchen), tel: 01298 872422 or visit www.churchwood.co.uk
- Lacanche** (oven), tel: 00 33 380 90 35 00 or visit www.lacanche.com
- Lapidica** (floor), tel: 01423 560262 or visit www.lapidica.co.uk
- Light Innovations Ltd**, tel: 020 8873 1582 or visit www.lightinnovation.com
- Perrin and Rowe** (mixer tap), tel: 01708 526361 or visit www.perrinandrowe.co.uk
- The Yorkshire Tile Company**, tel: 0114 273 1133 or visit www.ytc-tiles.com
- Villeroy & Boch** (sink), tel: 020 88756060 or visit www.villeroy-boch.com